

Greensforge Drive



Accommodation over three levels

Popular 'Souter' design, with garage

Sought after 'Rings' location within Ingleby Barwick

Ideal first purchase or 'buy to let'

Viewing advised

£175,000



Multi-Award Wining



Built to the very popular 'Souter' design by Persimmon Homes, with the rare feature of a garage which sits alongside with extra parking and an enclosed rear garden. Delivering spacious accommodation over three levels, and modern throughout, this property may prove an ideal first purchase or ideal 'buy to let' - which similar achieving in excess of £900 per calendar month - early viewing is advised.

Briefly, the accommodation comprises an entrance hall, living room, inner hall, cloakroom/WC and kitchen/diner to the ground floor. Two of the three double bedrooms are found to the first floor, along with the family bathrooms, whilst a lovely 'Master' with ensuite sits on the second floor.

GROUND FLOOR

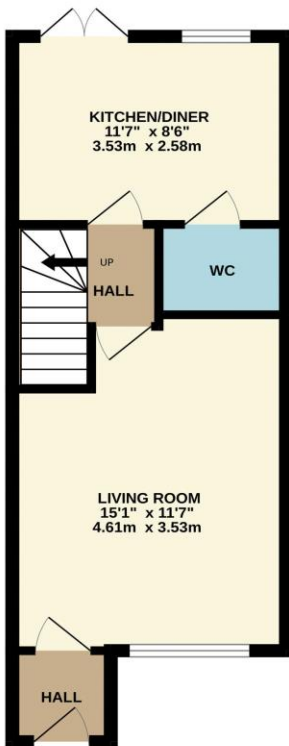

1ST FLOOR

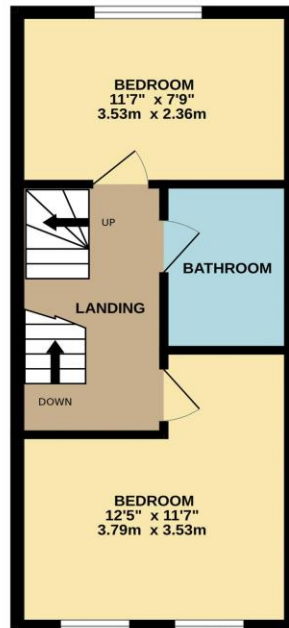

2ND FLOOR

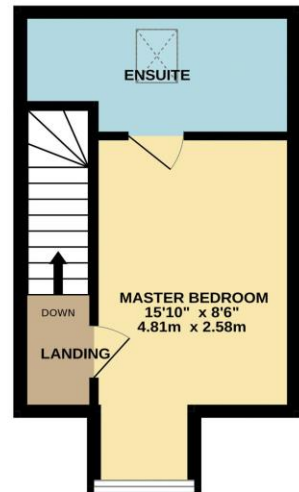

“The Ingleby Barwick Experts”





Tenure: Freehold

Council Tax Band: C

EPC Rating: TBC



AGENTS NOTE: Every care has been taken with the preparation of these details, but they are for general guidance only. Measurements and dimensions are approximate, and any fixtures or fittings shown in photography does not infer that they are to be included within the sale. The agent has not tested any appliances or supplies and professional verification of these should be sought prior to purchase if required. These particulars do not constitute a contract or part of a contract.